

塞维拉空心导轨

对重侧导轨的设计旨在追求导轨重量和最大惯性矩之间的最佳平衡。

空心导轨有开放型和封闭型两种，每个种类均有不同的材质厚度规格，并按照塞维拉的生产标准制造。

Hollow Rails SAVERA

Guide rails for elevator counterweight designed to offer the optimal balance of maximum moment of inertia and minimum weight.

The hollow rails are available in both closed and open profiles with a comprehensive range of metal sheet thicknesses, and manufactured according to the production standards of Savera.

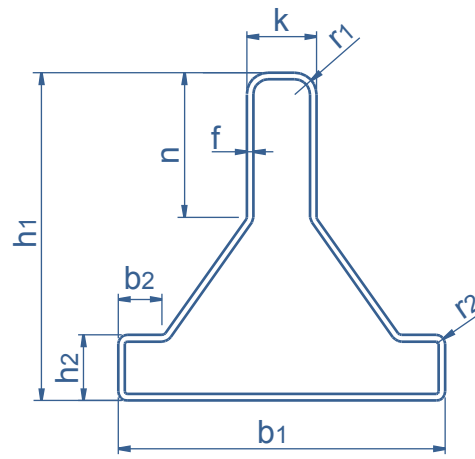

尺寸概述 (mm)		General dimensions (mm)								
	$b_1 \pm 1$	$h_1 \pm 0,20$	$k \pm 0,20$	$b_2^{+0,5}_{-0}$	h_2	n	$f \pm 0,08$	r_1	r_2	
HS75-1,5	75	75	16	10	15	32	1,5	5	4	
HS75-1,8	75	75	16	10	15	32	1,8	5	4	

技术参数		Technical Characteristics								
	截面 Section cm 2	重量 Weight kg/m	e cm	I_{xx} cm 4	W_{xx} cm 3	i_{xx} cm	I_{yy} cm 4	W_{yy} cm 3	i_{yy} cm	
HS75-1,5	3,92	3,07	2,67	24	4,97	2,47	16,51	4,4	2,05	
HS75-1,8	4,67	3,67	2,67	28,4	5,88	2,47	19,37	5,2	2,04	

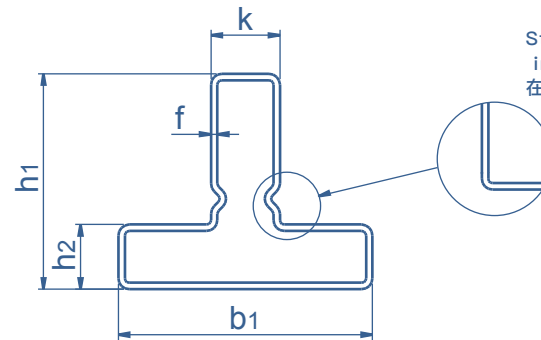

尺寸概述 (mm)		General dimensions (mm)				
	$b_1^{+2}_{-0}$	$h_1^{+0,6}_{-0}$	$k \pm 0,20$	$h_2^{+0,5}_{-0}$	$f \pm 0,08$	
SW59/1-2,0	59	50	16	15	2	
SW59/2-1,5	59	50	16	15	1,5	

技术参数		Technical Characteristics								
	截面 Section cm 2	重量 Weight kg/m	e cm	I_{xx} cm 4	W_{xx} cm 3	i_{xx} cm	I_{yy} cm 4	W_{yy} cm 3	i_{yy} cm	
SW59/1-2,0	4,08	3,22	1,78	10,43	3,24	1,6	10,65	3,61	1,61	
SW59/2-1,5	3,16	2,48	1,78	8,1	2,52	1,6	8,6	2,87	1,65	

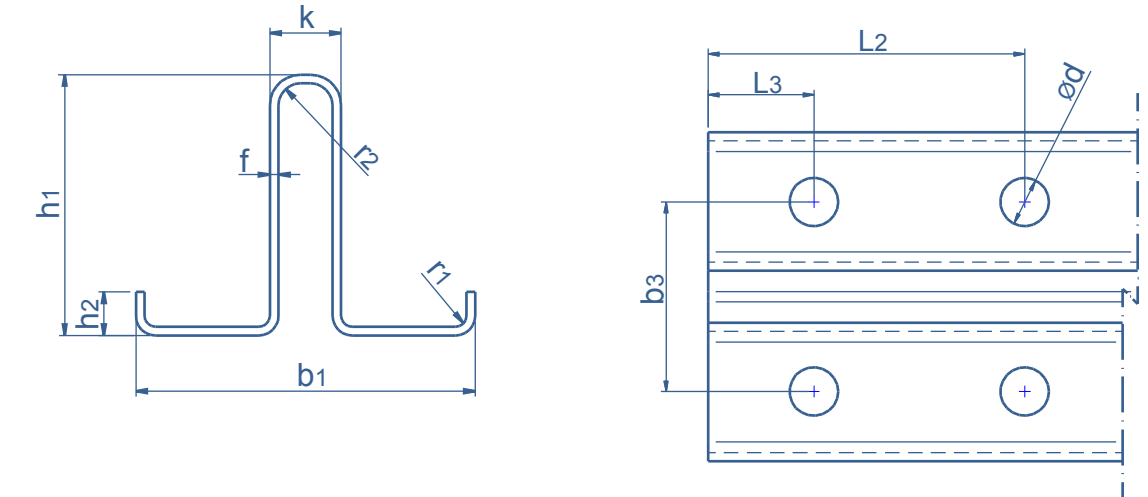
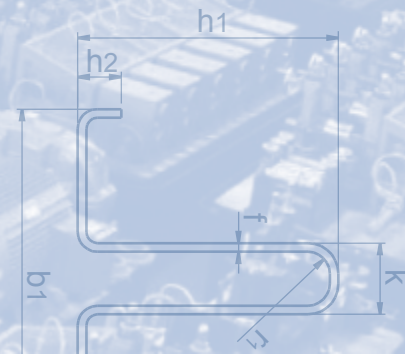



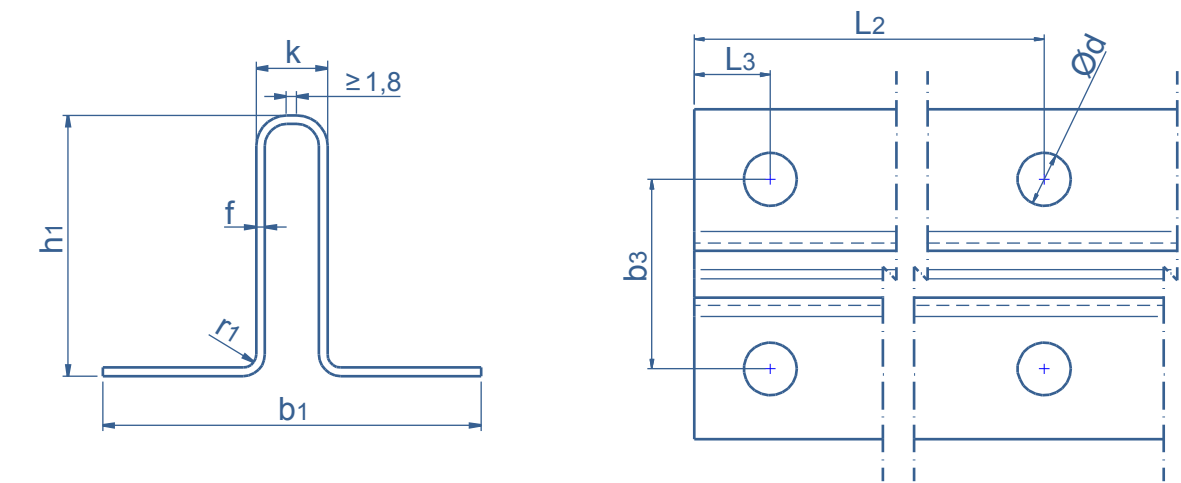

尺寸概述 (mm)		General dimensions (mm)										
	$b_1 \pm 1$	$h_1 \pm 0,3$	$k \pm 0,2$	$h_2 \pm 1$	$f^{+0,2}_{-0,15}$	r_2	r_1	d	$b_3 \pm 0,5$	$L_3 \pm 0,3$	$L_2 \pm 0,5$	
TK3A-2	78	60	16,4	10	2	5	2,5	11,5	45	25	75	
TK3A-2,3	78	60	16,4	10	2,3	5	2,5	11,5	45	25	75	
TK5A-2,75	78	60	16,4	10	2,75	5	3	11,5	45	25	75	
TK5A-3	78	60	16,4	10	3	5	3	11,5	45	25	75	
TK5A-3,2	78	60	16,4	10	3,2	5	3	11,5	45	25	75	

技术参数		Technical Characteristics								
	截面 Section cm 2	重量 Weight kg/m	e cm	I_{xx} cm 4	W_{xx} cm 3	i_{xx} cm	I_{yy} cm 4	W_{yy} cm 3	i_{yy} cm	
TK3A-2	3,94	3,09	2,1	15,98	4,10	2,01	11,89	3,05	1,74	
TK3A-2,3	4,36	3,42	2,1	18,39	4,72	2,05	14,28	3,66	1,81	
TK5A-2,75	5,33	4,18	2,1	20,78	5,33	1,97	16,16	4,14	1,74	
TK5A-3	5,8	4,55	2,1	22,86	5,86	1,99	17,5	4,49	1,74	
TK5A-3,2	6,16	4,84	2,1	24,14	6,19	1,98	18,37	4,71	1,73	



尺寸概述 (mm)		General dimensions (mm)									
	$b_1 \pm 1$	$h_1 \pm 0,3$	$k \pm 0,4$	$f^{+0,2}_{-0,15}$	r_1	d	$b_3 \pm 0,5$	$L_3 \pm 0,3$	$L_2 \pm 0,5$		
TK3	87	60	16,4	2	3	14	50	20	180		
TK5-3,2	87	60	16,4	3,2	3	14	50	20	180		

技术参数		Technical Characteristics								
	截面 Section cm 2	重量 Weight kg/m	e cm	I_{xx} cm 4	W_{xx} cm 3	i_{xx} cm	I_{yy} cm 4	W_{yy} cm 3	i_{yy} cm	
TK3	3,88	3,05	2,1	16,43	4,21	2,06	12,09	2,78	1,77	
TK5-3,2	6,14	4,82	2,07	24,99	6,36	2,02	19,04	4,38	1,76	

			长度 Length (mm)	Ra max. (μm)				材料 Material
	f/5m XX (mm)	f/5m YY (mm)			Twist / m	S	Sq1	
HS75-1,5	2,5	2,5	±3	6,3	0,5°	±0,3mm	±0,3mm	SGC340
HS75-1,8	2,5	2,5	±3		0,5°	±0,3mm		
SW59/1-2,0	3,5	3,5	±2		0,5°	±0,3mm		
SW59/2-1,5	3,5	3,5	±2		0,5°	±0,3mm		
TK3A-2	3	2	±3		0,7°	+20'+60'	±0,3mm	Q235
TK3A-2,3	3	2	±3		0,7°	+20'+60'		
TK5A-2,75	3	2	±3		0,7°	+20'+60'		
TK5A-3	3	2	±3		0,7°	+20'+60'		
TK5A-3,2	3	2	±3		0,7°	+20'+60'		
TK3	3	2	±3		0,7°	+20'+60'		
TK5-3,2	3	2	±3	0,7°	+20'+60'			

Surface coating for all types:
所有规格的表面处理:
- Galvanised 镀锌 > 6 μm

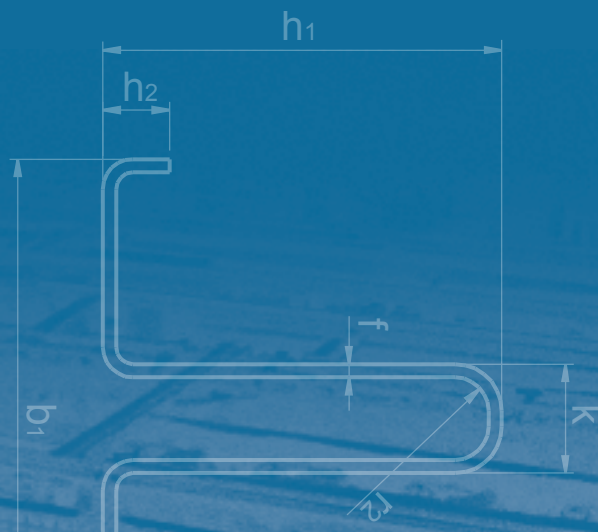

Rev. 11/24
Actualización vigente disponible en : www.saveragroup.com
Current updates available on : www.saveragroup.com

Contact info and more on:
savera@saveragroup.com

Hollow Rails

塞维拉空心导轨
Hollow Rails Savera

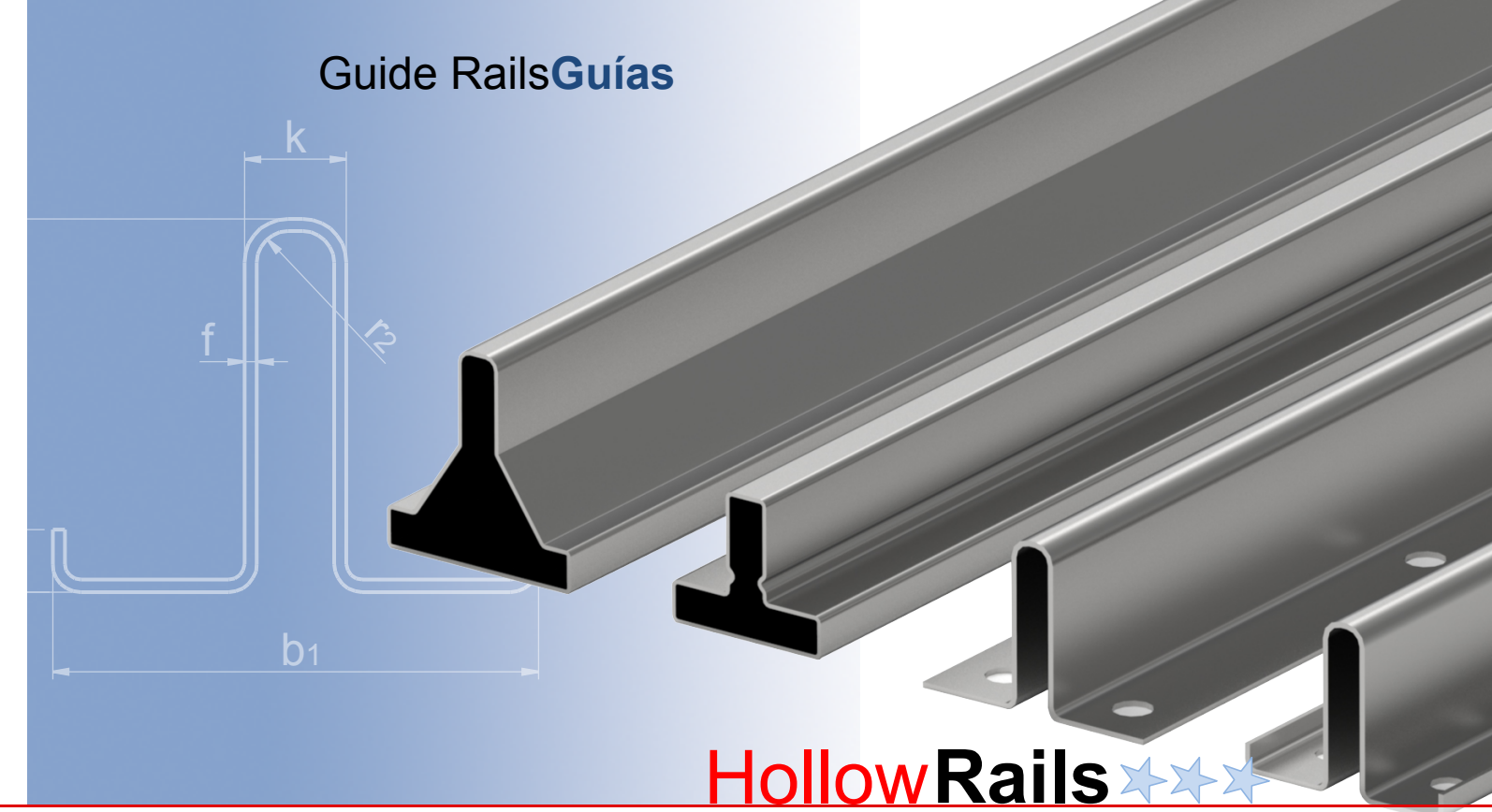

Hollow Rails

塞维拉空心导轨
Hollow Rails Savera



Elevator System Solutions



Elevator System Solutions